

# AALTO

**TYPE PH1**  
383 sq.m.  
#26-08  
(Lower Level)

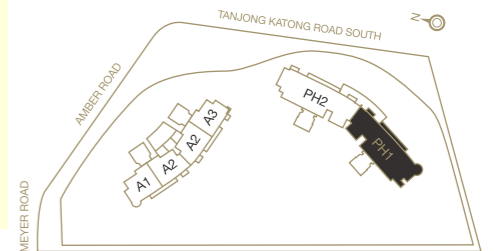
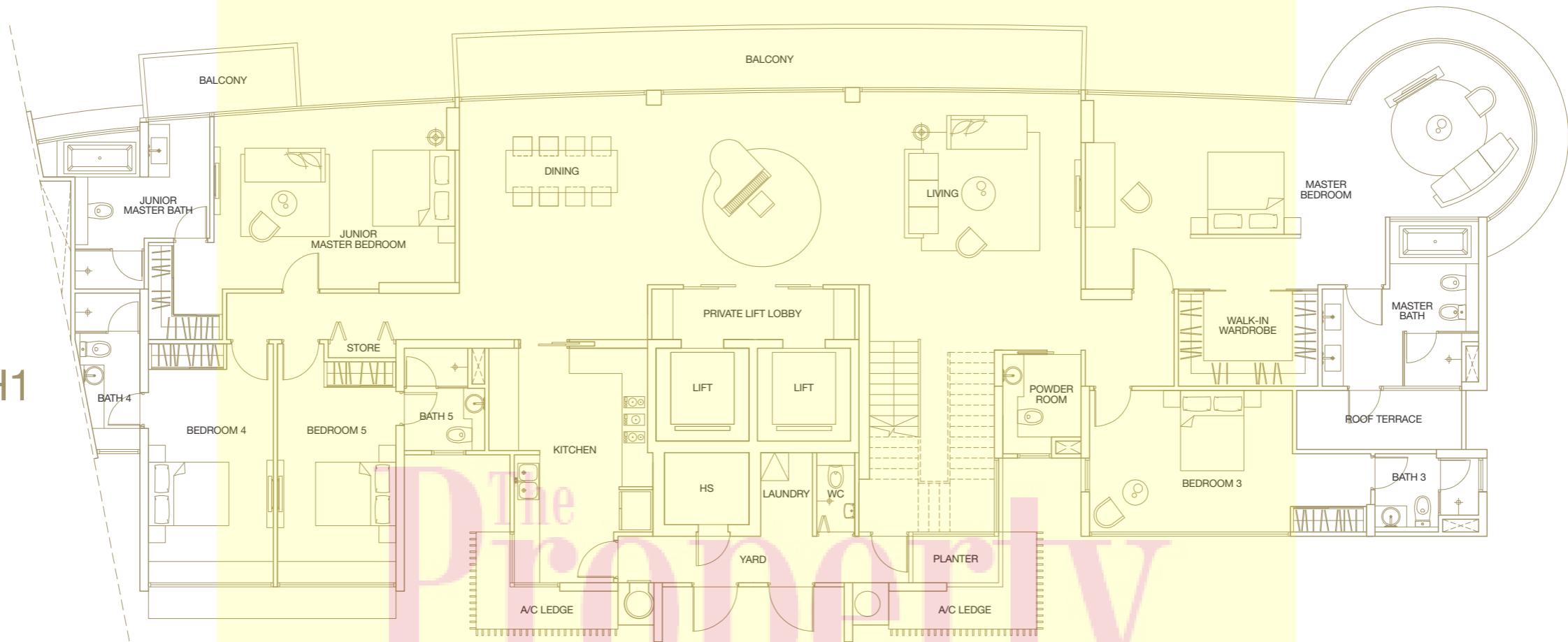

All plans are not to scale and subject to change as may be approved by the relevant authorities. Indicated floor areas are approximate and subject to final survey.  
Note: A/C Ledge - Air-con Ledge, HS - Household Shelter, BW - Bay Window.

# AALTO

**TYPE PH1**  
176 sq.m.  
#26-08  
(Upper Level)

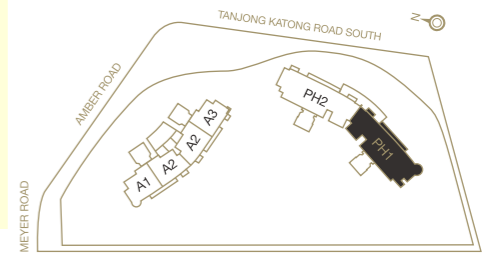
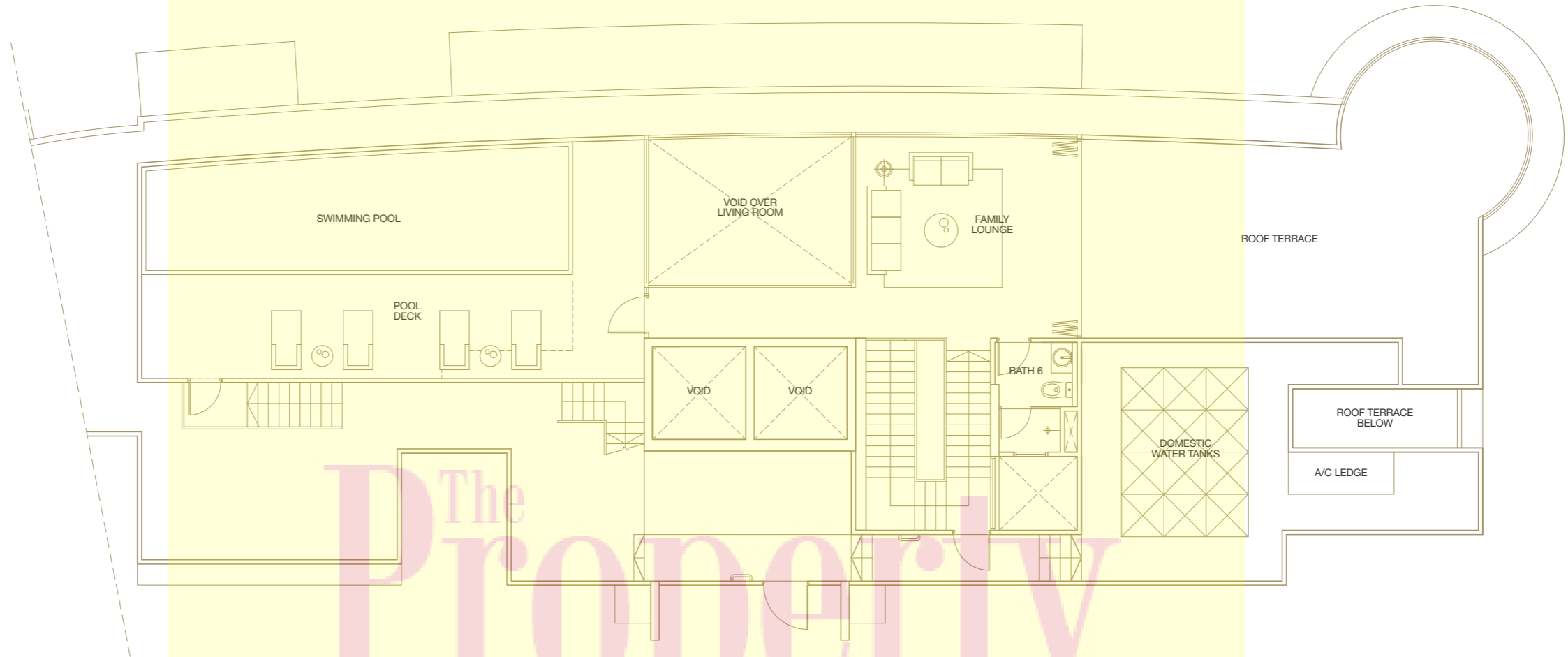

All plans are not to scale and subject to change as may be approved by the relevant authorities. Indicated floor areas are approximate and subject to final survey.  
Note: A/C Ledge - Air-con Ledge, HS - Household Shelter. Dotted line at Pool Deck indicates filtration pump room and balancing tank below Pool Deck.

# AALTO

## TYPE PH2

358 sq.m.

#26-06

(Lower Level)

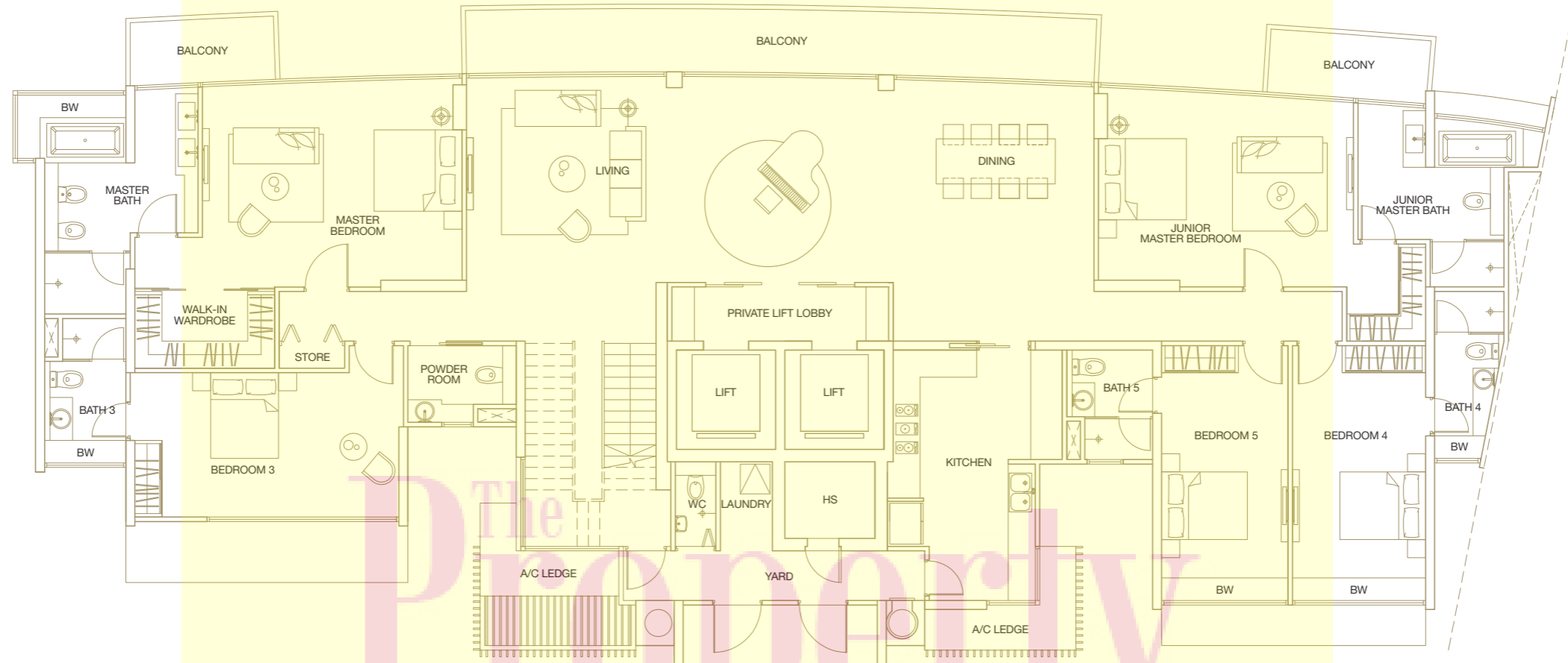

The Property collection.com

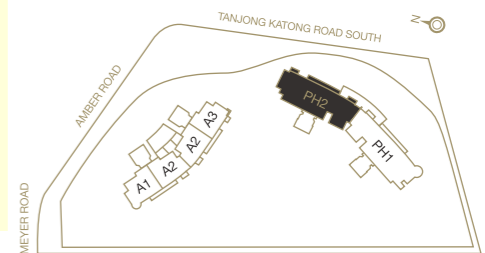

All plans are not to scale and subject to change as may be approved by the relevant authorities. Indicated floor areas are approximate and subject to final survey.  
Note: A/C Ledge - Air-con Ledge, HS - Household Shelter, BW - Bay Window.

# AALTO

## TYPE PH2

146 sq.m.

#26-06

(Upper Level)

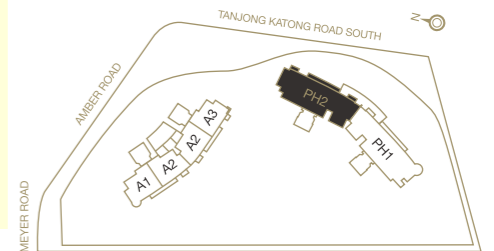
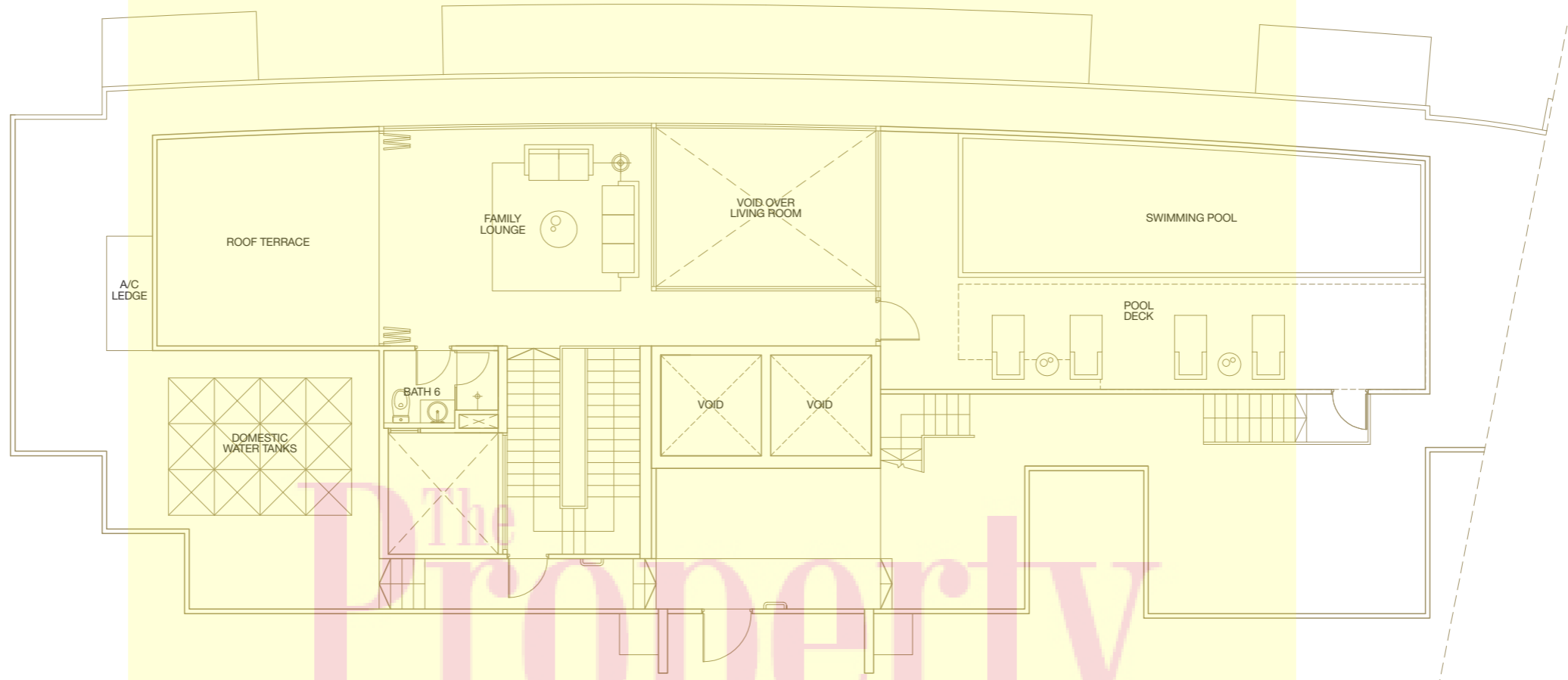

All plans are not to scale and subject to change as may be approved by the relevant authorities. Indicated floor areas are approximate and subject to final survey.  
Note: A/C Ledge - Air-con Ledge, HS - Household Shelter. Dotted line at Pool Deck indicates filtration pump room and balancing tank below Pool Deck.

# AALTO

## TYPE SPH1

411 sq.m.  
#25-08

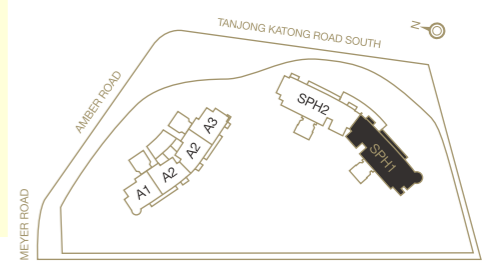
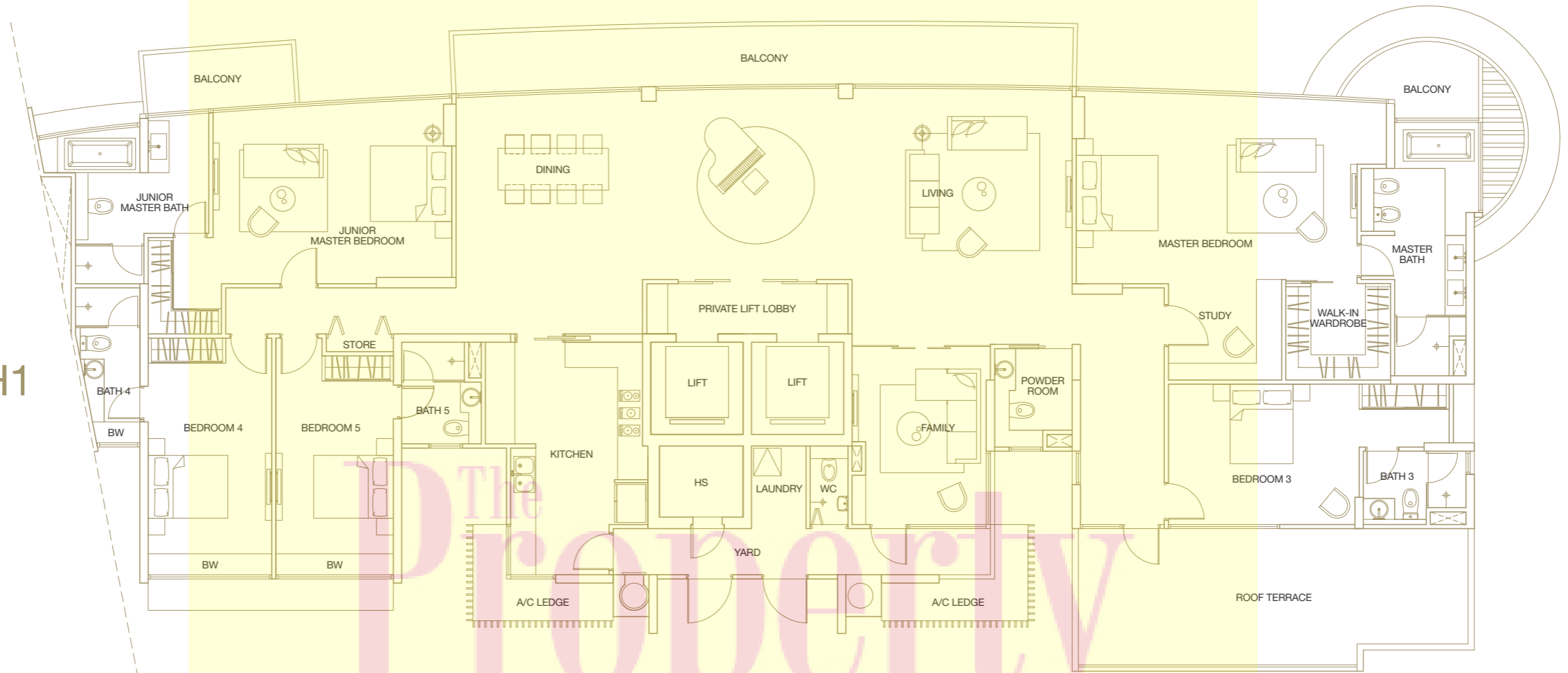

All plans are not to scale and subject to change as may be approved by the relevant authorities. Indicated floor areas are approximate and subject to final survey.  
Note: A/C Ledge - Air-con Ledge, HS - Household Shelter, BW - Bay Window.

# AALTO

## TYPE SPH2

366 sq.m.  
#25-06

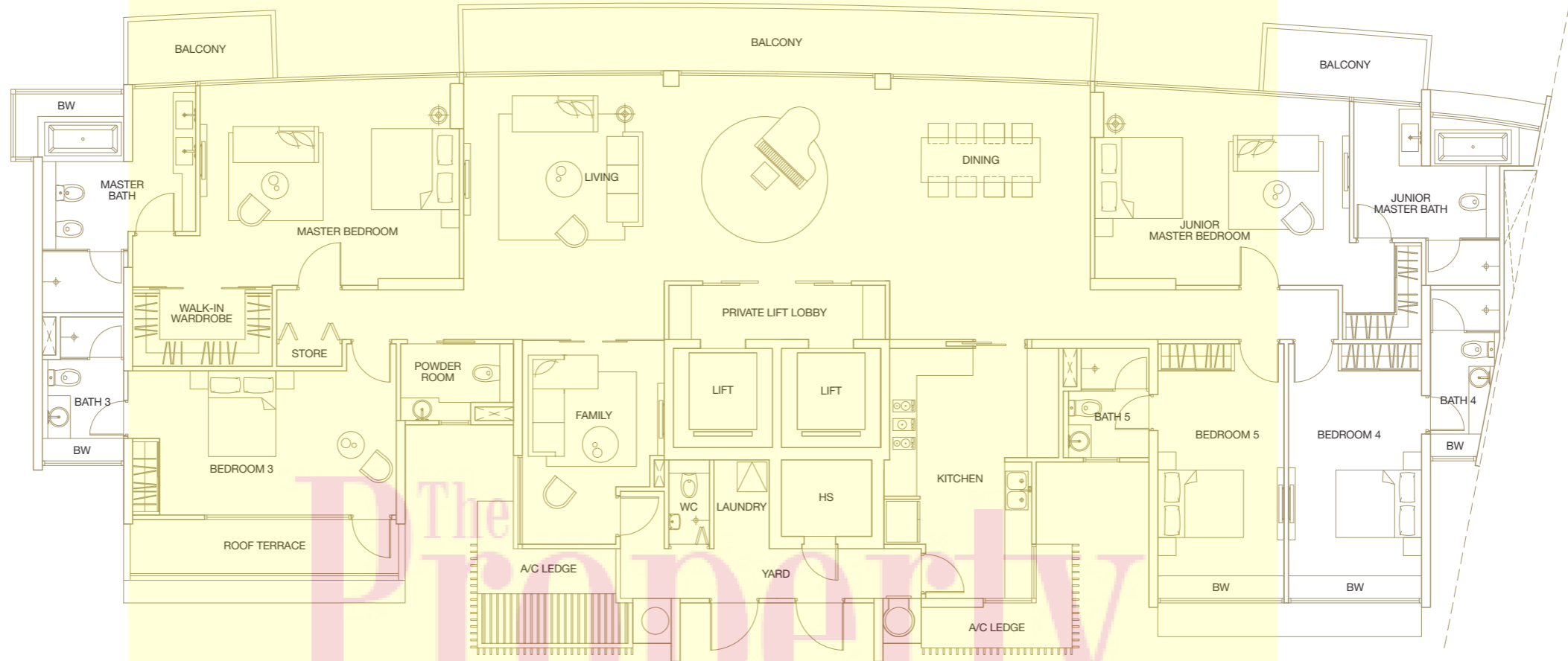

The Property collection.com

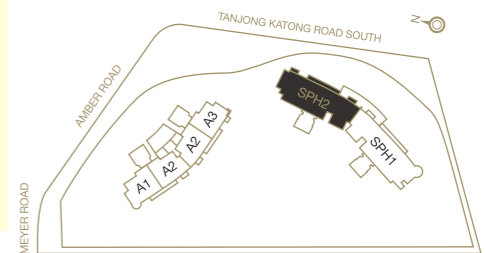

All plans are not to scale and subject to change as may be approved by the relevant authorities. Indicated floor areas are approximate and subject to final survey.  
Note: A/C Ledge - Air-con Ledge, HS - Household Shelter, BW - Bay Window.